



PROJECT CENTER

<http://www.cricut.com>



NATIVITY CARD



Design by: Dana01 (1 Project)

About me: I love to paint, make cards, scrapbooking, alter books, and finding new ideas to try.

Project skill level: moderate

Project time: 1 hour to 2 hours

Project tags: Christmas Winter

Spiritual/Religious Holiday Love Holiday Cards

Seasonal Cards Cards Holiday Décor

I used the New Testament Cartridge to make this card. I made it using a zigzag card pattern that I found on youtube. I had a good time making this card.

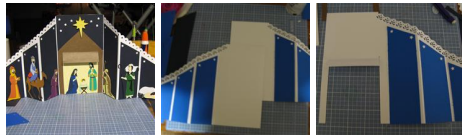

CRICUT®: WHAT WAS USED



Cricut Expression® Machine with Plantin SchoolBook and Accent Essentials®



Gypsy™ handheld design studio for Cricut®

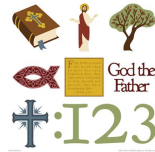

New Testament Cartridge

STEP 1

I started out with 2 8 1/2 X 11 cardstock sheets. After making the Zigzag folds (zigzag cards found on youtube). Then I used a border punch on top edges. For my background I cut 6 strips of blue card stock and cut the tops in an angle and used a star punch in corners. After gluing all the blue pieces I then cut the bottoms so they are even with the bottom of the card. Take one of the card halves and cut an opening for the stable leaving a flap (around 1") at top for the roof. I then took a square piece of dark blue card stock to use for the sky above the stable and used the star punch in the corners. Then I took brown card stock and cut a piece to look like a stable. Cutting a flap (around 1 1/4") to cover the roof that was cut out in the card. Taking the other half of the card I glued a piece of pale yellow card stock for the inside of the stable. Then glued the 2 cards together and added a larger star at top. I then glued my characters into place. The camel had to stick out passed fold to fit and still be able to fold card. Hope you enjoy my Nativity Card.

AWARDS



RELATED PROJECTS



Christmas Ornament Card



Word Collage Boards



Reindeer Pillow



[View details](#)



[View details](#)



[View details](#)

<http://www.cricut.com>